

# Refilling Instructions

for Hewlett-Packard C1823/C6625/C6578 Series Tri-Color Cartridges

## CONTENTS:

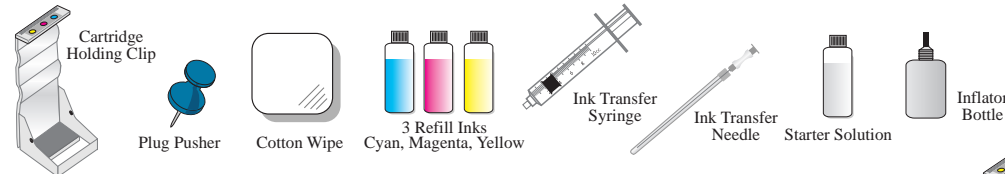

**IMPORTANT: READ INSTRUCTIONS ALL THE WAY THROUGH BEFORE STARTING TO REFILL!**

1. Remove cartridge from printer when “color ink low” message appears.

2. Snap cartridge firmly into cartridge holding clip. (See illustration 1.)

*Note: The cartridge holding clip has yellow, magenta and cyan colored dots near the cartridge fill holes to indicate the correct location of the color chambers in the cartridge. IGNORE label on cartridge.*

3. Using the plug pusher, push all three plugs located at the top of the cartridge into the cartridge by using a steady firm pressure. (See illustration 2.)

4. Twist ink transfer needle onto ink transfer syringe by holding needle at base and twisting it in the clockwise direction. (See illustration 3.)

5. CAREFULLY remove the plastic needle shield from the needle. **WARNING! Needle is VERY SHARP! KEEP OUT OF REACH OF CHILDREN.** Save the plastic needle shield for storing the needle between uses.

6. Shake starter solution bottle well. Uncap starter solution bottle.

**NOTE: YOU WILL BE REPEATING STEPS 7 THROUGH 12 THREE TIMES (ONCE FOR EACH COLOR)**

7. Insert needle and draw only 1cc of solution into syringe. (See illustration 4.)

8. Insert the needle into the yellow ink chamber until only \*1/4 inch (6mm) of the metal needle is exposed. Dispense the starter solution into the ink chamber by depressing the syringe plunger. (See illustration 5.)  
\* When filling the magenta chamber 1/2 inch (12mm) should be exposed.

9. Withdraw the needle from the ink chamber and set aside.

NOTE: If cartridge has been empty for more than several days the starter solution should be dispensed into all three ink chambers, cleaning the needle between colors. The cartridge should then be allowed to stand overnight before adding the inks.

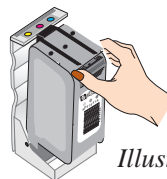

Illustration 1

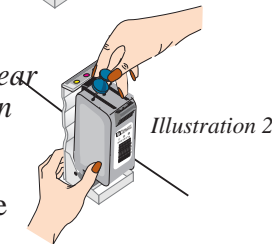

Illustration 2



Illustration 3



Illustration 4

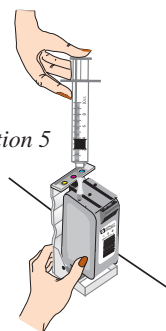
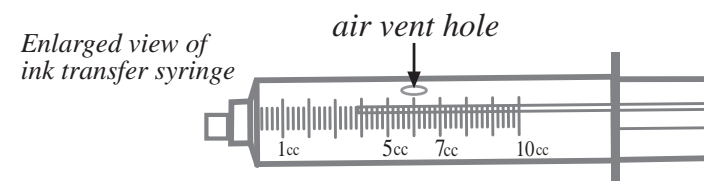

Illustration 5

10. Uncap the yellow ink bottle. Insert the needle and draw only 5cc of ink into the syringe. Recap the ink bottle and put it back in the box. (See illustration 6.)

Illustration 6

11. Insert the needle straight down into the yellow ink chamber until only 1/4 inch (6mm) of the metal needle is exposed. SLOWLY draw the syringe plunger out to the 7cc mark. Ink should start to gravity flow into the cartridge. (See illustration 7.) If the ink stops flowing before the syringe is empty depress the plunger very gently until ink starts to flow again. When empty, remove syringe from cartridge.



Enlarged view of ink transfer syringe

Illustration 7

12. Flush the syringe and needle by drawing clean tap water from a glass into the syringe and expelling it several times and finally wiping the needle dry with the cotton wiping cloth. NOTE: Use fresh water for each color.

13. Repeat steps 7 through 12 for the magenta ink chamber using magenta ink. Finally repeat 7 through 12 for the cyan ink chamber using cyan ink.

14. Remove the cartridge from the cartridge holding clip. Wipe the printhead area with the cotton wiping cloth. Reinstall in the printer.

**NOTE: DO NOT SEAL THE THREE FILL HOLES! Air must be allowed to enter the cartridge as the ink prints out.**

15. Store remaining refill supplies **out of the reach of children** for future use. Save the plastic needle shield for disposal of needle after last use.

*If you encounter problems getting one or more of the colors to print, refer to the “Refilling Tips” sheet included with the kit.*

IF YOU HAVE ANY QUESTIONS OR ENCOUNTER ANY DIFFICULTY IN USING THIS PRODUCT, PLEASE CONTACT:

**REPEAT-O-TYPE**  
MANUFACTURING CORPORATION  
ESTABLISHED 1931

665 State Highway 23 • Wayne, NJ 07470-6892 U.S.A. • (973) 696-3330 • (800) 288-3330  
Fax: (973) 694-7287 • Email: help@repeatotype.com

Hewlett-Packard is a trademark of Hewlett-Packard Company. ©2001 Repeat-O-Type Manufacturing Corporation.