

FLOOR PLAN
SCALE: 3/64"=1'-0"

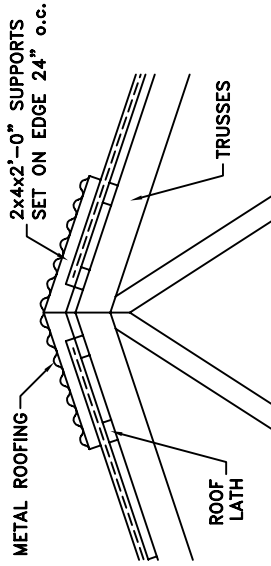

RIDGE VENT DETAIL
SCALE: 3/8"=1'-0"

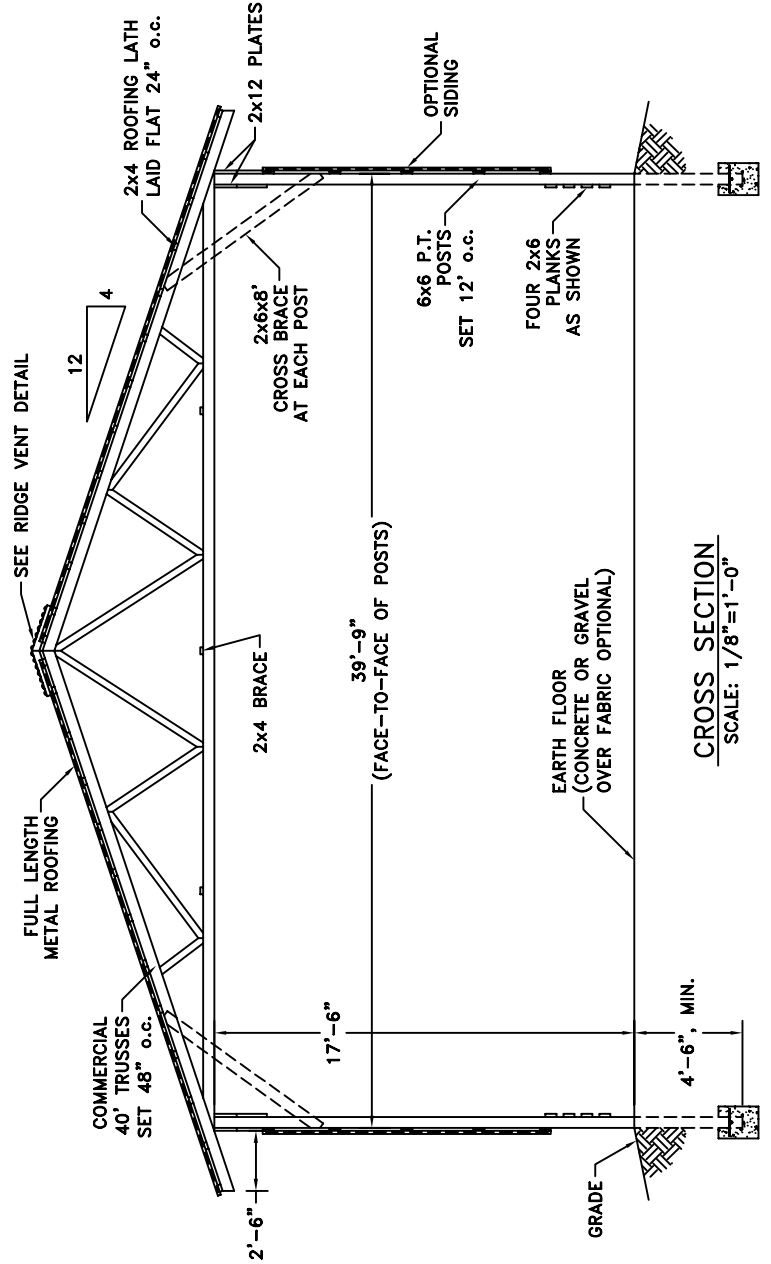

CROSS SECTION
SCALE: 1/8"=1'-0"

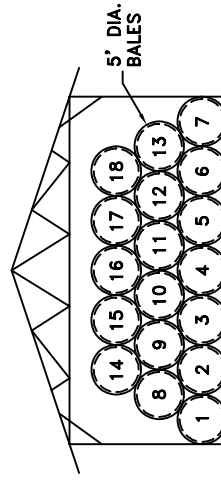

BALE STACKING DIAGRAM
SCALE: 3/64"=1'-0"

COOPERATIVE EXTENSION WORK IN AGRICULTURE AND HOME ECONOMICS	
STATE OF TENNESSEE	
THE UNIVERSITY OF TENNESSEE	
INDUSTRIAL ENGINEERING & SOIL SCIENCE DEPARTMENT	
UNITED STATES DEPARTMENT OF AGRICULTURE COOPERATING	
40' x 96' HAY STORAGE FOR BIG ROUND BALES	
TENN	04-DEC-2006
GFG	PLAN NO. 14182
	SHEET 1 OF 2

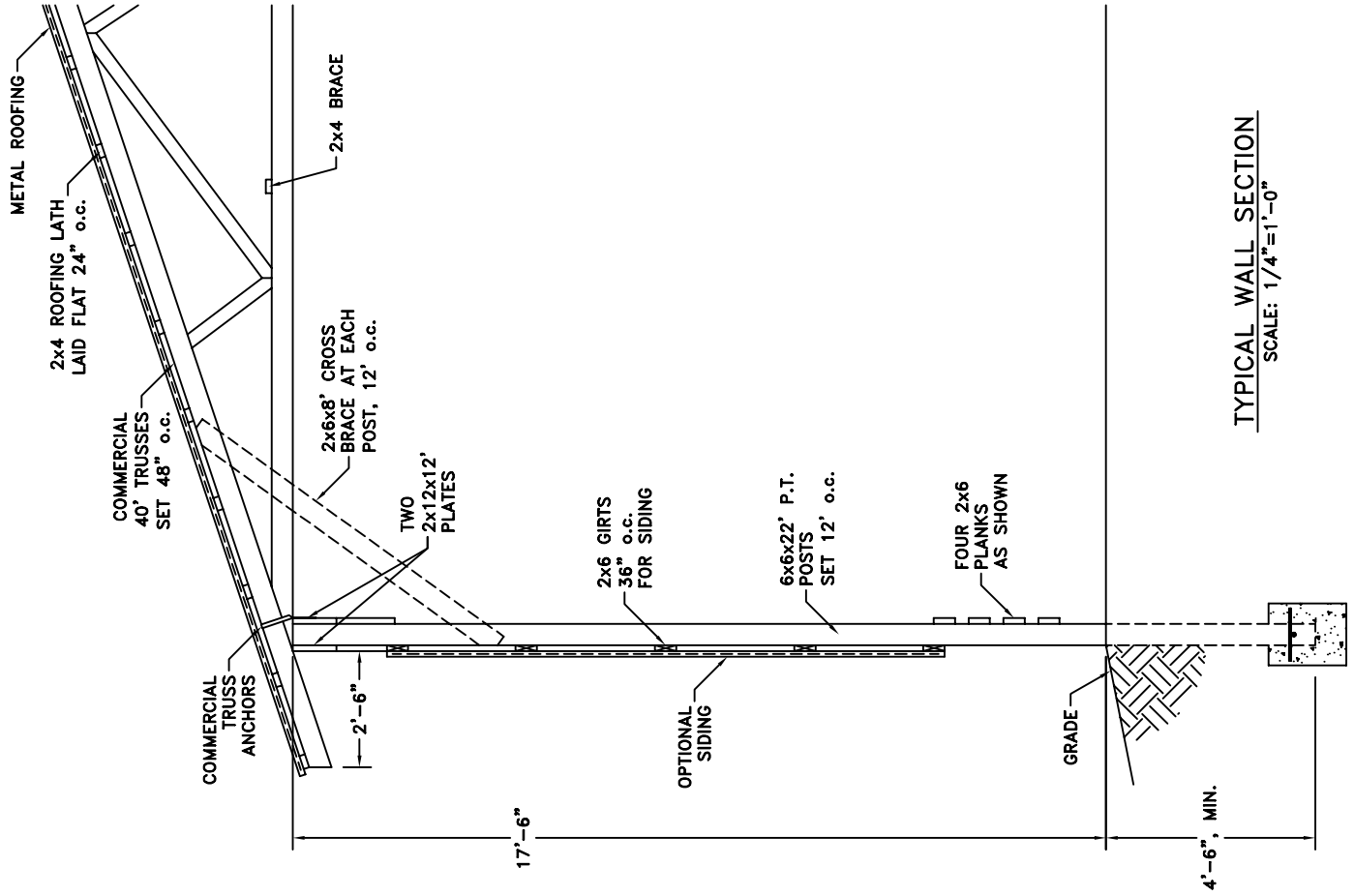

TYPICAL WALL SECTION

SCALE: 1/4"=1'-0"

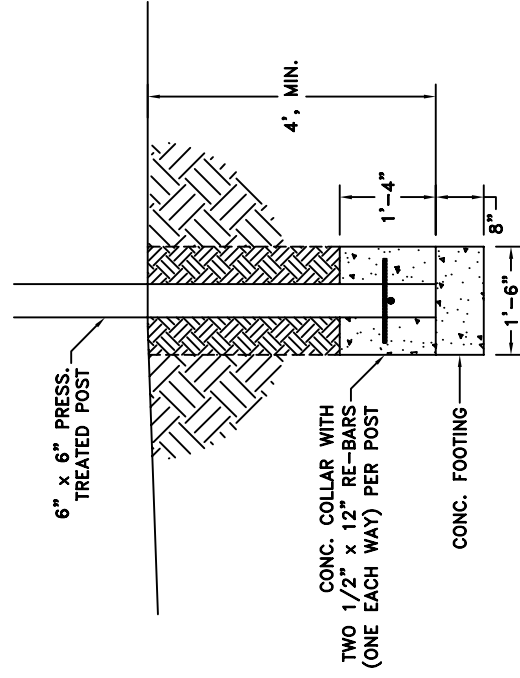
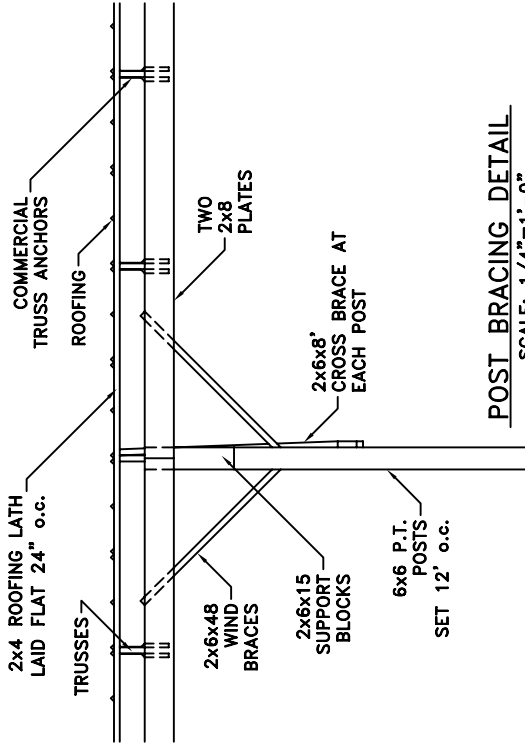

POST FOUNDATION DETAIL

SCALE: 3/8"=1'-0"

NOTE:
IF 6" DIAMETER x 4' LONG BALES ARE STORED, INCREASE BARN HEIGHT BY 2'-6". THIS BARN WILL THEN STORE APPROXIMATELY 315 BALES. (21 STACKS OF 15 BALES PER STACK.)

COOPERATIVE EXTENSION WORK IN AGRICULTURE AND HOME ECONOMICS	
STATE OF TENNESSEE	
THE UNIVERSITY OF TENNESSEE	
INSTITUTIONAL ENGINEERING & SOIL SCIENCE DEPARTMENT	
UNITED STATES DEPARTMENT OF AGRICULTURE COOPERATING	
40' x 96' HAY STORAGE	
TENN	04-DEC-2006
GFG	PLAN NO. 14182
SHEET 2 OF 2	