

SECTION "C-C"

MANUFACTURED TRUSSES SPECIFICALLY DESIGNED FOR OVERHANG) TO BE SET 4'-0" ON CENTER AND ANCHORED TO PLATES WITH STRAPS OR TRUSS ANCHORS

2"x4" PURLINS LAID FLAT 24" O.C.

METAL ROOFING



SECTION "B-B"

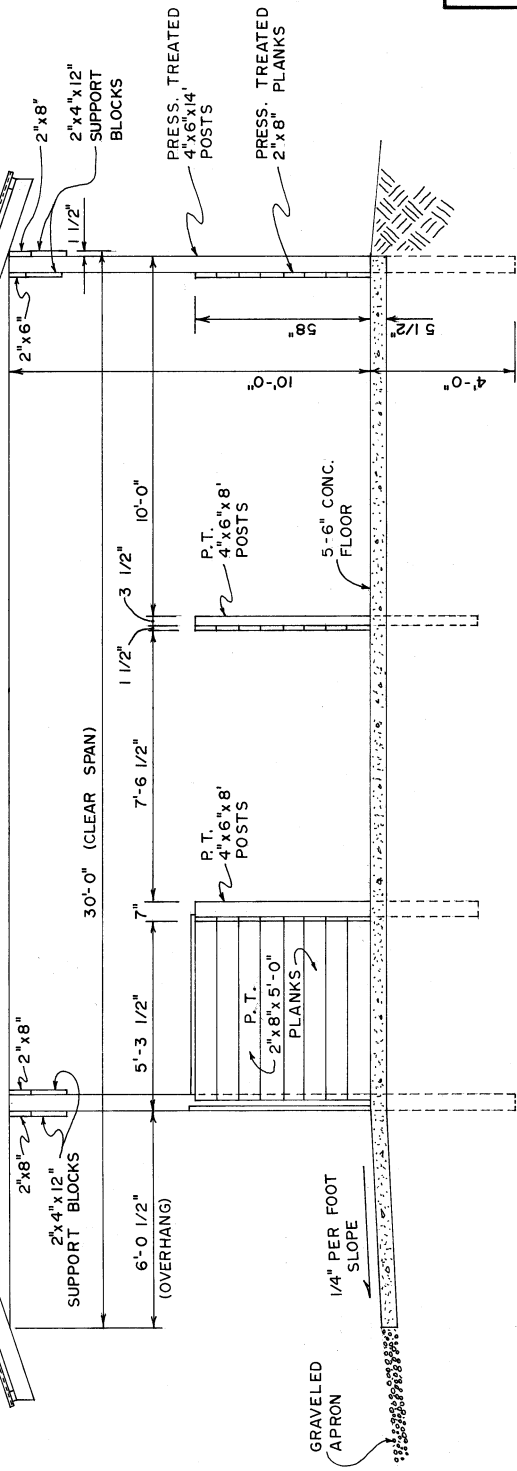
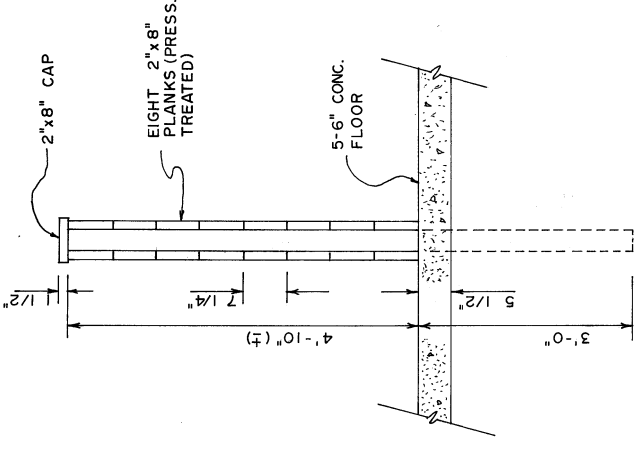

SECTION "A-A"